

Phase angle controller

IRG1-D



- New generation of IRG1-D phase angle controller in proven design (100% downward compatible)
- Available with swing amplitude control
- Includes user data storage, soft start and stop, and full and half-wave operating modes

Type	IRG1-D
A	175 mm
B	80 mm
C	61.5 mm
D	9 mm
E	25 mm
F	52 mm
G	163 mm
ØH	5.5 mm

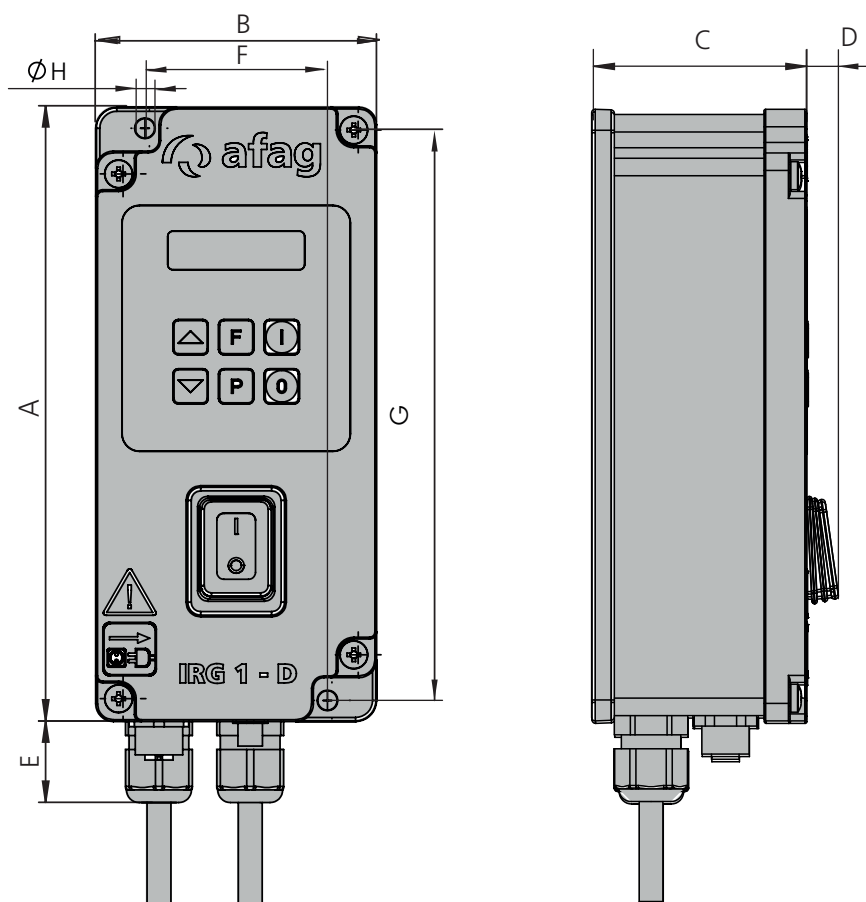



IRG1-D

Type	IRG1-D 230 V/50 Hz	IRG1-D 110 V/60 Hz	IRG1-D 230 V/50 Hz	IRG1-D 110 V/60 Hz
Order number	50544383	50544384	50574617	50574618
Oscillation amplitude control	Yes	Yes	No	No
Operating voltage	230 VAC ±10%	230 VAC ±10%	230 VAC ±10%	230 VAC ±10%
Operating frequency	50 Hz	60 Hz	50 Hz	60 Hz
Mechan. vibration frequency (alternation oper. / continuous oper.)	50 Hz / 100 Hz	60 Hz / 120 Hz	50 Hz / 100 Hz	60 Hz / 120 Hz
Output voltage	40-220 VAC	20-105 VAC	40-220 VAC	20-105 VAC
Nominal output current	0-6 A	0-6 A	0-6 A	0-6 A
Protection type	IP 54	IP 54	IP 54	IP 54
Fuses	2 x 6.3 A	2 x 6.3 A	2 x 6.3 A	2 x 6.3 A
Connection type mains	2m cable with Schuko plug	2m cable with NEMA5-15 plug	2m cable with Schuko plug	2m cable with NEMA5-15 plug
Connection type vibratory feeder	2m cable 3 x 1 mm ²	2m cable 3 x 1 mm ²	2m cable 3 x 1 mm ²	2m cable 3 x 1 mm ²
Release (optocoupler)	24 VDC	24 VDC	24 VDC	24 VDC
Smooth start	0-60 s	0-60 s	0-60 s	0-60 s
Smooth stop	0-60 s	0-60 s	0-60 s	0-60 s
Operating temperature	0 - 40 °C	0 - 40 °C	0 - 40 °C	0 - 40 °C
Weight	1.06 kg	1.06 kg	1.06 kg	1.06 kg

Sensor angle IRG1-D

Order number 50549361

Net weight 0.28 kg

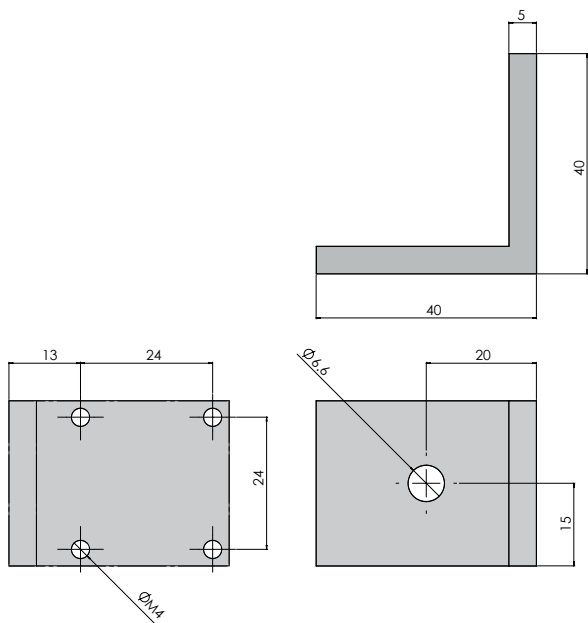

Included in delivery

■ -

Acceleration sensor SWC 62

Order number 50547573

Net weight 0.03 kg

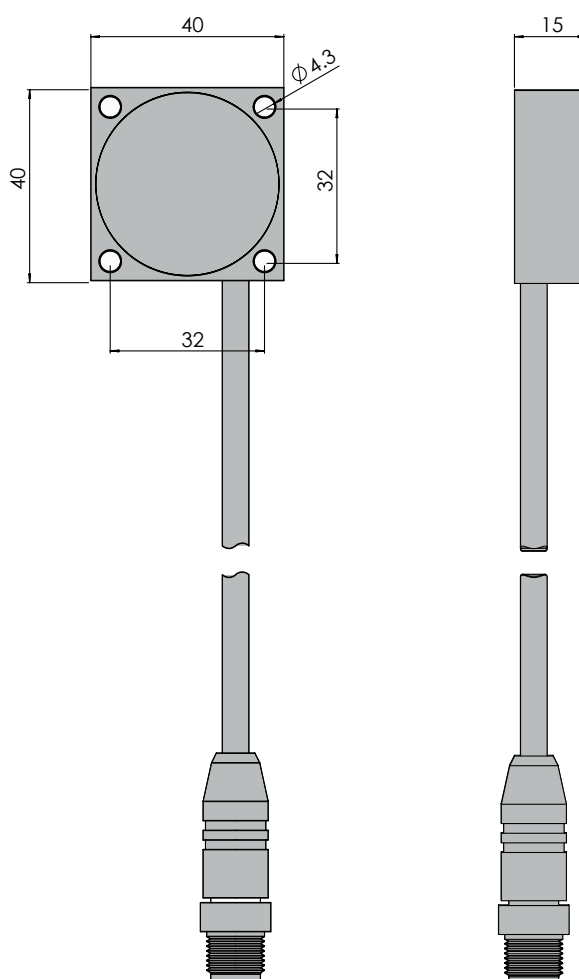

Included in delivery

■ -